

CHROMIC SURGICAL CATGUT

EN

Surgical Catgut ABSORBABLE Suture Classification III

Colour Coding Suture pack - Brown, Thread - Brown

Needle Image / Length 1/2 = 1/2 Circle needle

3/8 = 3/8 Circle needle

Length (eg. 35mm) = Stretched length of the needle in mm

● Round Bodied Taper

● A-Cute® (RB Cutting Tip)

▼ Reverse Cutting

▼ Reverse Premium Cutting Point (PCP)

▼ Straight Cutting

↗ Blunt

▲ Conventional Cutting

▽ Special Cutting

▣ Fineline® Cutting

▽ Lancet-Spatula (side cutting)

CV300 Unique Stainless Steel Material (high bending resistance, yet flexible when bent)

Met Refers to the thread diameter in 1/10mm
The number above Met (eg. 2/0) explains the thread size in USP/EP



Expiry Date (year, month)

LOT

Refers to the batch number and allows full traceability

STERILE

Sterile

STERILE R

Method of sterilisation R = gamma irradiation



Do not reuse



Caution

REF

Reference number



Do not use if package is damaged



Date of manufacture



Manufacturer's name and address



Recyclable materials



Do not re-sterilise



Fragile, handle with care



Consult Instructions For Use



Keep away from sunlight



Keep dry



Store below 25°C



Store below 25°C



Store below 25°C



Store below 25°C



Store below 25°C



Store below 25°C



Store below 25°C



Store below 25°C



Store below 25°C



Store below 25°C



Store below 25°C



Store below 25°C



Store below 25°C



Store below 25°C



Store below 25°C



Store below 25°C



Store below 25°C



Store below 25°C



Store below 25°C



Store below 25°C



Store below 25°C



Store below 25°C



Store below 25°C



Store below 25°C



Store below 25°C



Store below 25°C



Store below 25°C



Store below 25°C



Store below 25°C



Store below 25°C



Store below 25°C



Store below 25°C



Store below 25°C



Store below 25°C



Store below 25°C



Store below 25°C



Store below 25°C



Store below 25°C



Store below 25°C



Store below 25°C



Store below 25°C



Store below 25°C



Store below 25°C



Store below 25°C



Store below 25°C



Store below 25°C



Store below 25°C



Store below 25°C



Store below 25°C



Store below 25°C



Store below 25°C



Store below 25°C



Store below 25°C



Store below 25°C



Store below 25°C

Description - Chromic Surgical Catgut sutures are manufactured from the intestinal serosa. The suture is supplied as a spun fiber that has been centreless ground and polished. Chromic Surgical Catgut is supplied chromicised (0.15 – 0.30%). Surgical catgut sutures are absorbable. Chromic Catgut is intended to be absorbed within 20 to 40 days. All catgut sutures are supplied in a solution of isopropanol / demineralised water. The catgut is only sourced from BSE Negligible Risk countries.

Intended Use – Chromic Surgical Catgut sutures are indicated for use in general soft tissue approximation.
To be used in procedures requiring an absorbable suture.

Actions - Chromic Surgical Catgut sutures may cause tissue reaction.

Indications - Chromic Surgical Catgut sutures should only be used in surgical procedures requiring an absorbable suture or ligature.

Contraindications - None

Warnings - Chromic Surgical Catgut sutures are supplied sterile and are single use only devices. Chromic Surgical Catgut sutures should not be re-sterilised under any circumstance. **Sterility is not guaranteed if the suture package is damaged or opened.**

Do not open the pack prematurely or do not leave the pack opened for a prolonged period of time, as the alcohol solution will evaporate.

Chromic Surgical Catgut sutures are for use by appropriately trained personnel only. Users should be familiar with surgical techniques involving absorbable sutures before employing Chromic Surgical Catgut.

All decision and responsibility regarding the selection, use of the suture and interpretation contained in this instructions for use, remains that of the user.

WE DO NOT RECOMMEND THAT THIS SUTURE IS DIPPED, SOAKED OR RUN THROUGH ANY SOLUTIONS. Once it is removed from the packet, it should be used or discarded.

Instructions for Use - Knot tying requires the standard surgical technique of flat and square ties with additional throws as indicated by surgical circumstance and the experience of the end user.

For easy handling and opening of the suture pack, please refer to Fig. 1. As with all sutures, care should be exercised during handling and use to avoid compromising the suture. In particular, precaution should be taken when using surgical instruments such as needle holders to grasp the suture. Instruments should be in good working condition with no sharp edges to avoid crushing or severing the suture. In all instances, the suture should only be held at the free end.

To prevent needle detachment the needle should be held away from the shank, approximately one third of the way down. The operator should not grasp the needle by the point as this could damage it. Please refer to Fig. 2.

Supplied - Chromic Surgical Catgut sutures are supplied in various sizes and lengths, with or without pre-attached stainless steel needles of varying length, curvature and cutting profile. Standard sizes range from USP 6/0 to 3 (Metric 1 to 7). Other sizes may be available upon request.

Storage - Chromic Surgical Catgut sutures should be stored at temperatures below 25 degrees Celsius at 50% relative humidity and away from direct heat and moisture to ensure that packaging integrity is maintained.

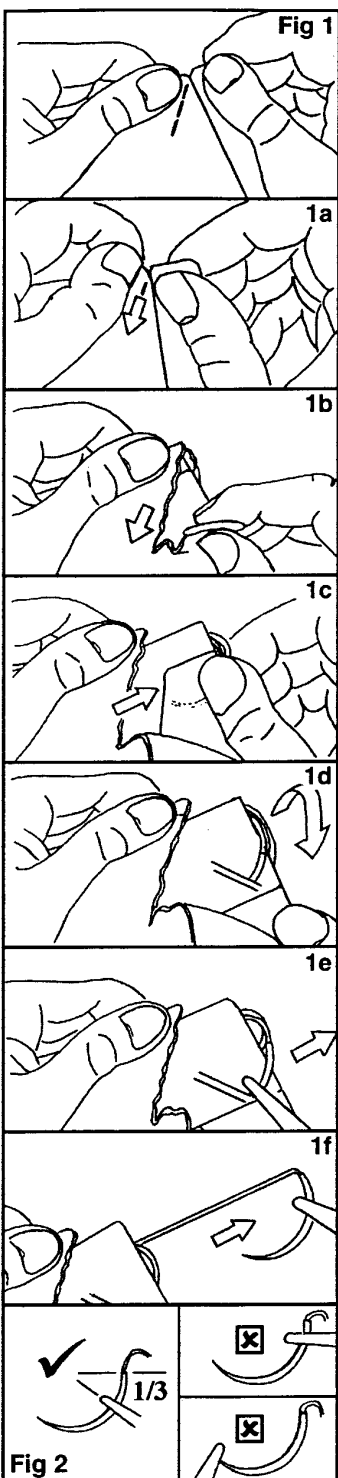

Dyneck Pty Ltd
9 Circuit Drive, Hendon SA 5014, Australia
Tel. +61 8 8268 2033 Fax +61 8 8347 0434
Website: www.dynek.com
Email: dynek@dynek.com

ISO 13485

REF: IFU-CG/Rev8 Date Issued: 25/03/2022